



About Lower Fort Garry Estates

Lower Fort Garry Estates is located in the Lockport area of the Rural Municipality of St. Andrews.

Located across the National Historical Site of Lower Fort Garry on PTH number 9, the subdivision offers its inhabitants the opportunity to experience city living in a country setting. Surrounded by gorgeous landscaped property on the west bank of the Red River, Lower Fort Garry adds to the overall beauty of this community .

Just 28 kilometers (17.4 miles) from downtown Winnipeg with all the conveniences, comforts, and privacy of a country estate and minutes from fishing and golfing, Lower Fort Garry Estates offers a great value for those who make it their home. Lots are generously sized (minimum 60,000 sq. ft = 1.377 acres) and spread out for comfort, as well as to fulfill dreams. Only single family homes with minimum size and pre-approved exterior elevations will be built.

The sense of community is often overlooked in these days of rapidly expanding residential developments. That's why Lower Fort Garry Estates is a community built on old principals. Family values and traditional ideas are strong influences in the land plan and overall design. Come visit our friendly neighbourhood and you'll discover that lets-take-a-walk feeling in a community you'll want to call home.

Site Plan

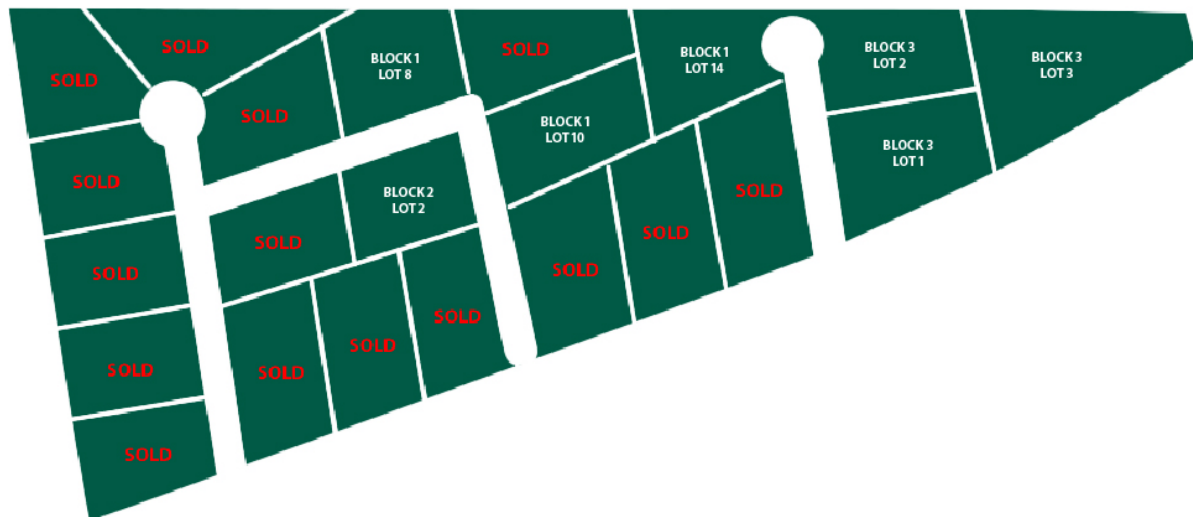

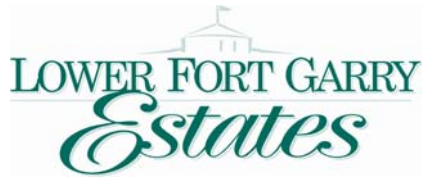

Lot Breakdown

Block	Lot	Plan	Area	Frontage	Price*	Status
			Acres	Feet		
1	1	40491	1.48	204.2		SOLD
1	2	40491	1.38	200.0		SOLD
1	3	40491	1.38	200.0		SOLD
1	4	40491	1.38	200.0		SOLD
1	5	40491	1.50	137.6		SOLD
1	6	40491	1.42	287.2		SOLD
1	7	40491	1.40	190.3		SOLD
1	8	40491	1.45	275.0		SOLD
1	9	40491	1.45	201.2		SOLD
1	10	40491	1.42	200.0	69,900	AVAILABLE
1	11	40491	1.56	200.0		SOLD
1	12	40491	1.56	200.0		SOLD
1	13	40491	1.56	200.0		SOLD
1	14	40491	1.43	200.6		SOLD
2	1	40491	1.42	300.0		SOLD
2	2	40491	1.42	300.0		SOLD
2	3	40491	1.56	200.0		SOLD
2	4	40491	1.56	200.0		SOLD
2	5	40491	1.56	200.0		SOLD
3	1	40491	1.38	221.9	64,900	AVAILABLE
3	2	40491	1.44	204.3	59,900	AVAILABLE
3	3	40491	2.67	912.0	150,000	AVAILABLE

*** All prices subject to change without notice.**

